

## Revolutionary SIP phone with a 7-inch touch-panel function

The SIP-T48G is Yealink's most recent innovative IP Phone for a fast-changing world. Designed specifically for both local and international use by business, industry and commerce, it incorporates a large touch panel that makes switching between different screens and applications swift, easy and convenient. Yealink's Optima HD technology very carefully creates the impression that you are sitting virtually face-to-face opposite the person at the other end of the call. The T48G is also built for the Gigabit Ethernet and facilitates very rapid call handling and the application of accessories such as a Bluetooth USB Dongle, plus wired and wireless headsets. The new IP Phone supports impressive productivity-enhancing features too which make it the natural and obvious efficiency tool for today's busy executives and professionals.



Optima  
HD Voice



7 inch  
touch screen



Gigabit



Paperless



Support  
Bluetooth Earphone



### Key Features and Benefits

#### Revolutionarily new design

Yealink's SIP Phones continue to evolve, the SIP-T4 Series have been designed by pursuing ease of use in even the tiniest details, these new design include 7 inch touch screen, scratch-resistant surface, metallic texture, non-slip rubber feet, ergonomic recessed buttons etc.

#### HD Audio

Yealink Optima HD Voice refers to the combination of software and hardware design as well as the implementation of wideband technology to maximize the acoustic performance. Coupled with advanced acoustic clarity technology such as full duplex, echo cancellation, adaptive jitter buffer etc. Creating an amazing face-to-face live experience.

#### A rich visual experience for applications

SIP-T48G Supports vast productivity-enhancing feature such as XML Browser, call forward, call transfer, 3-way conferencing and a superior UC experience. the 7" 800 x 480-pixel color touch screen with backlight enables rich visual presentation and easier navigation of the menu.

#### Advanced connectivity

For network connectivity, the SIP-T48G comes with two Gigabit Ethernet ports, one of them suitable for Power over Ethernet. Built-in a USB port, support Bluetooth headset through USB Dongle.

#### Highly secure transport and interoperability

The Communicator uses SIP over Transport Layer Security (TLS/SSL) to provide service providers the latest technology for enhanced network security. The range is certified compatible with 3CX, Asterisk and BroadSoft Broadworks, ensuring excellent compatibility with leading soft switch suppliers.

- > Revolutionarily new design
- > Yealink Optima HD voice
- > Dual-port Gigabit Ethernet
- > PoE support
- > 7" 800 x 480-pixel color touch screen with backlight
- > Support Bluetooth headset through USB Dongle
- > Up to 6 SIP accounts
- > Paper label free design
- > Headset, EHS support
- > Supports expansion modules
- > Wall mountable
- > Simple, flexible and secure provisioning options

## Audio Features

- > HD voice: HD handset, HD speaker
- > Codecs: G.722, G.711(A/μ), G.723.1, G.729AB, G.726, iLBC
- > DTMF: In-band, Out-of-band(RFC 2833) and SIP INFO
- > Full-duplex hands-free speakerphone with AEC
- > VAD, CNG, AEC, PLC, AJB, AGC

## Phone Features

- > 6 VoIP accounts
- > Call hold, mute, DND
- > One-touch speed dial, hotline
- > Call forward, call waiting, call transfer
- > Group listening, emergency call
- > Redial, call return, auto answer
- > 3-way conferencing
- > Direct IP call without SIP proxy
- > Ring tone selection/import/delete
- > Set date time manually or automatically
- > Dial plan, XML Browser, action URL/URI

## Directory

- > Local phonebook up to 1000 entries
- > Black list
- > XML/LDAP remote phonebook
- > Intelligent search method
- > Phonebook search/import/export
- > Call history: dialed/received/missed/forwarded

## IP-PBX Features

- > Busy Lamp Field (BLF)
- > Bridged Line Appearance(BLA)
- > Anonymous call, anonymous call rejection
- > Remote office, hot-desking
- > Message Waiting Indicator (MWI)
- > Voice mail, call park, call pickup
- > Intercom, paging, music on hold
- > Call completion, call recording

## Display and Indicator

- > 7" 800 x 480-pixel color touch screen with backlight
- > 24 bit depth color
- > LED for call and message waiting indication
- > Wallpaper
- > Intuitive user interface with icons and soft keys
- > National language selection
- > Caller ID with name, number and photo

## Feature keys

- > 29 one-touch DSS keys
- > 7 features keys: message, headset, hold, mute, transfer, redial, hands-free speakerphone
- > 6 navigation keys
- > Volume control keys
- > Illuminated mute key
- > Illuminated headset key
- > Illuminated hands-free speakerphone key

## Interface

- > Dual-port Gigabit Ethernet
- > Power over Ethernet (IEEE 802.3af), class 3
- > Built-in a USB port, support Bluetooth headset (Through USB Dongle)
- > 1xRJ9 (4P4C) handset port
- > 1xRJ9 (4P4C) headset port
- > 1XRJ12 (6P6C) EXT port: Supports up to 6 Expansion Modules for an attendant console application

## Other Physical Features

- > Wall mountable (optional)
- > External universal AC adapter (optional): AC 100~240V input and DC 5V/2A output
- > Power consumption (PSU): 2.0-6.4W
- > Power consumption (PoE): 2.4-10.5W
- > Dimension(W\*D\*H\*T): 266mm\*226mm\*185mm\*54mm
- > Operating humidity: 10~95%
- > Storage temperature: -10~50°C

## Management

- > Configuration: browser/phone/auto-provision
- > Auto provision via FTP/TFTP/HTTP/HTTPS for mass deploy
- > Auto-provision with PnP
- > Zero-sp-touch, TR-069
- > Phone lock for personal privacy protection
- > Reset to factory, reboot
- > Package tracing export, system log

## Network and Security

- > SIP v1 (RFC2543), v2 (RFC3261)
- > Call server redundancy supported
- > NAT transverse: STUN mode
- > Proxy mode and peer-to-peer SIP link mode
- > IP assignment: static/DHCP/PPPoE
- > HTTP/HTTPS web server
- > Time and date synchronization using SNTP
- > UDP/TCP/DNS-SRV(RFC 3263)
- > QoS: 802.1p/Q tagging (VLAN), Layer 3 ToS DSCP
- > SRTP for voice
- > Transport Layer Security (TLS)
- > HTTPS certificate manager
- > AES encryption for configuration file
- > Digest authentication using MD5/MD5-session
- > OpenVPN, IEEE802.1X
- > IPv6

## Package Features

- > Qty/CTN: 5 PCS
- > N.W/CTN:
- > G.W/CTN:
- > Giftbox size: 324mm\*263mm\*128mm
- > Carton Meas: 660mm\*338mm\*273mm

## Certifications

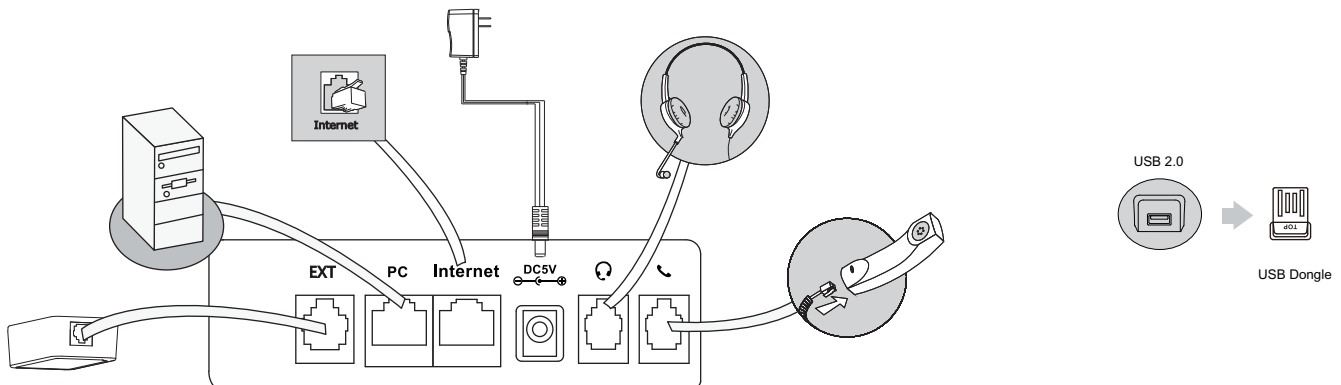

## Learn More

To find out how Yealink solutions can help your organization, visit us at [www.yealink.com](http://www.yealink.com) or mail to [sales@yealink.com](mailto:sales@yealink.com)